



# Bingara

# SHOW

# 2018

May 26 & 27

**BINGARA SHOW  
SOCIETY**

**President: Russell Smyth**

**0428 684 227**

**Secretary: Robyn Phillips**

**0409 770 994**

[www.bingarashow.com.au](http://www.bingarashow.com.au)



# Bingara Show Society Incorporated

## INDEX

Page 3	List of Events	Page 31	Rodeo
Page 4	Regulations	Page 33	<b>Section 5 - Poultry</b>
Page 5	Important Notices	Page 36	Poultry Entry Form
Page 7	Show Sponsors	Page 38	Entry Form Pavilion
Page 9	<b>Section 1 - Stud Beef Cattle</b>	Page 39	Pavilion Information
Page 12	Stud Cattle Entry Form	Page 40	<b>Section 6 - Farm Produce &amp;</b>
Page 13	<b>Section 2 - Horse Events</b>		<b>Section 7 - Garden Fruit &amp; Veg.</b>
Page 17	<b>Section 2 - Open Events Ponies</b>	Page 41	<b>Section 8 - Horticulture</b>
Page 19	<b>Section 2 - Open Events Galloways</b>	Page 43	Entertainment information
Page 20	<b>Section 2 - Open Events Hacks</b>	Page 44	<b>Section 9 - Handicraft</b>
Page 21	<b>Section 2 - Showjumping</b>	Page 45	<b>Section 10 - Cooking</b>
Page 22	<b>Section 2 - District Classes</b>	Page 46	<b>Section 11 - Jams, preserves etc</b>
Page 23	<b>Section 2 - Dressage</b>	Page 47	<b>Section 12 - Needlework &amp; Crochet</b>
Page 23	<b>Section 2 - Australian Stock Horses</b>	Page 49	<b>Section 13 - Knitting &amp; Crochet</b>
Page 25	<b>Section 2 - Campdraft</b>	Page 51	<b>Section 14 - Photography</b>
Page 26	Campdraft Entry Form	Page 52	<b>Section 15 - Art and</b>
Page 27	<b>Section 2 - Show Hunters</b>		<b>Section 16 - Collectors' Corner</b>
Page 29	Horse events entry form	Page 53	<b>Section 16 - Home Brew</b>
Page 30	<b>Section 3 - Wool</b>		Competition
	<b>Section 4 - Sheep</b>	Page 55	Regulations

## Map of Bingara Show Grounds

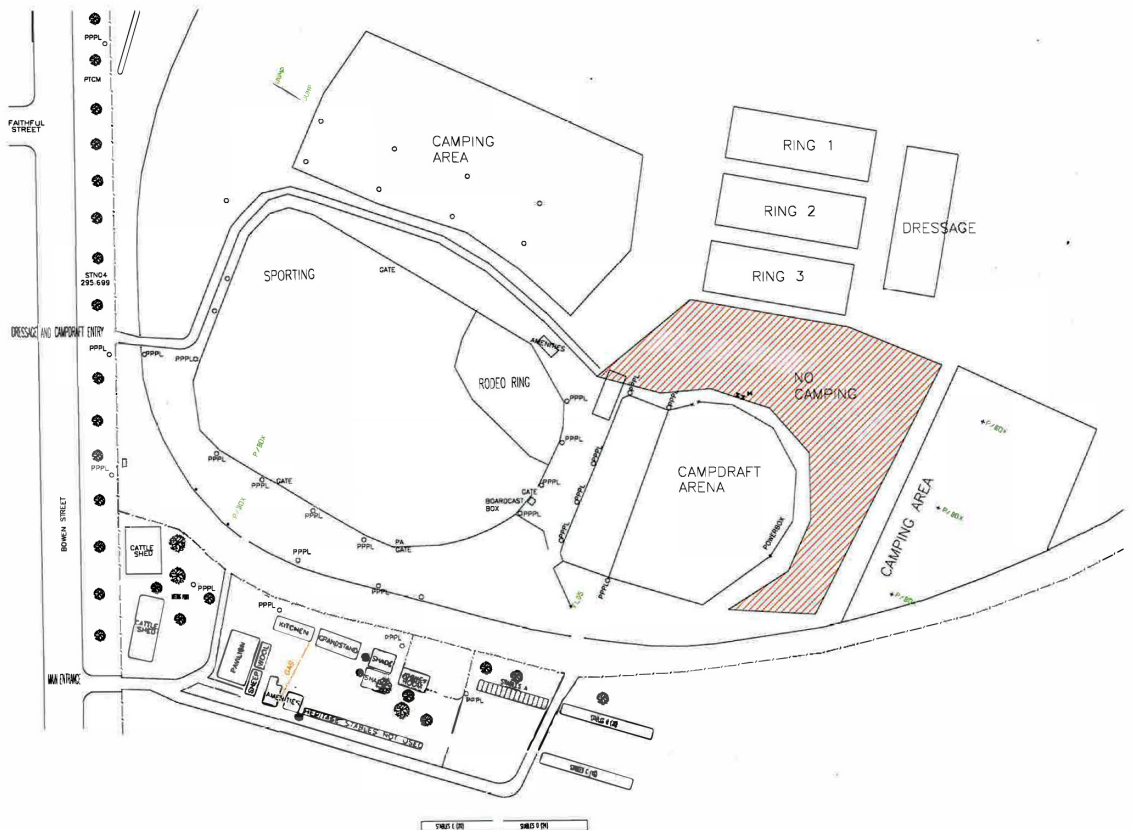

# SHOW SPONSORS

## MAJOR SPONSORS

Northern Slopes Landcare Assn (NSLA)  
Bingara IGA  
Booroomooka Angus Stud  
McGregor Livestock and Property  
McGregor Gourlay, Bingara  
The Telstra Shop, Inverell  
Wesfarmers Federation Insurance,  
David de Ferranti, Area Manager

## BUSINESS SPONSORS

AJ Hart Building Services  
Austbrokers RWA (Barraba)  
B & B Marshalls Haulage  
Bakers Barn Saddlery, Inverell  
Bike Territory, Castletop  
Bingara Veterinary Clinic  
Campbell's Fuel, Inverell  
Courallie Herefords  
East West Angus  
Elders Inverell  
Fosters Earthmoving and Transport  
Frame Rural Agencies, Inverell  
Frates Fruit and Veg, Inverell  
George and Gwen Boland  
Goodas Wool, Inverell  
Hart Rural Agencies, Barraba/Manilla  
Imperial Hotel, Bingara  
Jac's Carwash, Inverell  
Keystone Pastoral  
Lehman Stock and Property, Inverell  
Liberty Service Station, Inverell  
Meat on Maitland  
Minnie Vale Charolais

Ray White Rural, Bingara  
Ray White Rural, Inverell  
Southwell Partnership  
Thornleigh Stud  
The Sportsman's Hotel, Bingara  
Wade Street Meats, Inverell

## CLUB SPONSORS

Bingara Garden Club  
Bingara Lions  
Bingara Pony Club  
Bingara Sporting Club  
CWA Bingara Branch

## PRIVATE SPONSORS

Bingara Show barbecue men  
Marlene Brown  
Catherine and Ian Egan  
Alison Hosegood  
Laila Hosegood  
Ray Hull  
E and S Kelly  
Alf King  
Gay Mack  
PC and AM Mack  
Lindy Mill  
Kate Muir  
HR Munro  
Richard and Jenny Trigger  
The Whitfeld family  
The Withers family  
David and Frances Young

# Bingara Show Society Incorporated

## Your Association

YOUR ASSOCIATION is vitally interested in the wellbeing and growth of the district. YOUR SUPPORT is vital to the efficient functioning and growth of your Association. THE PRESIDENT and COMMITTEE are most appreciative of the valuable and practical assistance given by members, donors of prizes and patrons.

## Membership Prices

Members' Subscriptions become due on the 1st July of each year and are payable in advance for 2018. Members' Subscription - \$10 single; \$20 double; Family Subscription - \$25 which entitles entry for partner and all children 16 years and under. If you wish to become a member of the Society contact Secretary: Robyn Phillips on 0409 770 994 for nomination form. A list of all PAID MEMBERS will be kept at each entry gate.

## Exhibitors

Pavilion exhibits will not be received by the Secretary at her office, excepting those forwarded by post or transport, which must be firmly packed, bearing the senders name, Section and Class No. for which the exhibit is intended. Mailed exhibits will be re-packed and returned after the Show if requested. Postage must be prepaid on all mailed exhibits. All Pavilion exhibits must be staged and presented for judging by midday on Friday, 25 May 2018. Sections closing later are clearly stated at the top of each Section.

## Gate Charges:

**MEMBERS:** PAID MEMBERS listed at each entry gate (including vehicles and horses) - FREE

**NON- MEMBERS:** \$10 Single, \$20 Double - Concession \$5 - CHILDREN: (16 years and under) \$5.

**FAMILY PASS:** \$25 for the duration of the Show.

**CAMPING FEE:** \$15 for the duration of the show

**HORSE STALLS:** \$10 for the duration of the show

Bookings and payments to Carolyn Robinson 0428 851 984  
(bookings tentative until payment received)

## Industrial Stands:

Space allotted by Secretary. Charges: \$30 for 3x3m. Trade space application available upon request.

## Side Shows:

Space allotted by the Chief Sideshow Steward. Charges negotiated with Showmans Guild Representative.

## Notice to all Dog Owners

Any dog found loose or wandering will be impounded by the Ordinance Officer. Owners must remove dog faeces and rubbish immediately.

## Conditions of Entry

Competitors/Exhibitors hereby agree to abide by any decision of the Society in regard to entries and agree to compete/exhibit at their own risk and to indemnify and keep indemnified the Society against all claims, suits, actions or demands which may be brought against it in respect of any injuries or other losses sustained by them in the course of competing/exhibiting in any event/s and/or class/es and agree to exonerate the Bingara Show Society from all loss or injury whether from alleged negligence or otherwise.

**A WAIVER FORM must be signed before any entry for horse/cattle sections is accepted. All competitors/exhibitors are required to have their own Ambulance Cover. The Society will not be responsible for payment of ambulance transport costs.**

# Bingara Show Society Incorporated

## Important Notice To all Competitors/Exhibitors

All persons intending to ride, show animals or offer rides involving animals are required to sign an indemnity form prior to competing.

COMPETITORS are asked to call at front of Show Secretary's office prior to competing and sign forms and be given a wristband to show Ring Stewards when competing.

Forms can be downloaded and completed prior to event.

The forms are available for:

1. Competitors - over 18 years old.
2. Competitors - under 18 years old - Note: this to be signed by parent or guardian

## Important Notice to all Exhibitors

Any exhibitor intending to bring electrical equipment to the Showground will be required to ensure that such equipment is fitted with earth leakage circuit breakers and that all electrical leads, tool and appliances have been inspected and tagged by a licensed contractor. This is essential for the safety of yourself, fellow exhibitors and the general public and is a requirement of the Workplace Health and Safety Act, 2011. The Act imposes severe penalties in the event of noncompliance with its provisions. Any exhibitors who do not comply will not be allowed to exhibit at the Bingara Showground. Please check all your electrical equipment and leads before you come.

**Electric leads must be overhead or buried - this is a legal requirement and inspectors will police.**

## Abuse of Judges and Officials

The decision of the judges shall be final and any competitor or exhibitor who abuses either Judges or Officials and is found guilty, after enquiry by the Committee, shall be disqualified from further participation in this Show. A report shall be immediately forwarded to the Northwest Group of Show Societies and Pastoral and Agricultural Associations and will result in automatic suspension of the Competitor or exhibitor from all shows for the remainder of the season.

**Please note that NO DOGS are allowed on the Showground.**

***Enjoy Our Show***

# PLEASE NOTE

**PIC and details of last event attended are required.  
PREFILLABLE WAIVER FORMS ARE AVAILABLE ON  
THE ASC WEBSITE AND CAN BE BROUGHT WITH YOU  
TO SAVE TIME**



# Sections 6 - 16 Pavilion

President: Kate Muir 0428 241 929

Chief Steward: Laila Hosegood 0434 236 436

## Information to all Pavilion Exhibitors

Welcome to the 2018 Bingara Show Pavilion. We look forward to seeing your wonderful exhibits. The Pavilion will be open for inspection from 9am to 5pm Saturday, May 26 and from 9am to 12noon, Sunday, May 27.

### PLEASE READ THE FOLLOWING INFORMATION:

- Please read carefully the conditions of entry for each Section.
- Exhibits will be accepted from 9am-12 noon Friday, May 25.
- The Pavilion will be closed from 12 noon Friday. Judging commences at 12.30pm.
- Only Stewards and Judges will be allowed in the Pavilion from 12noon Friday until 9am Saturday morning.
- The Pavilion will not be open for inspection until 9am Saturday, May 26, and 10am Sunday, May 27.
- **Entry fees in all Sections are \$1.00.**
- **Entries submitted by the Bingara Central School and Preschool are free.**
- Exhibits and prizes to be collected from 12noon to 1pm on Sunday, May 27.
- In a class where only one entry is submitted it will be at the discretion of the judge to award a first, second or highly commended.
- Number of prizes awarded in any class will be at the discretion of the judge.
- Prize money for each class is First \$3, Second \$1.50.
- Winners of Champion prizes will not receive the individual class prize money.
- Any prize money not collected will remain the property of the Bingara Show Society.
- Supreme Pavilion Exhibit: \$50 fuel voucher + Ribbon.
- Meat Packers Prize: \$50 as judged by the BBQ men.
- Lucky entry prize for adult: \$20, and Junior Girl: \$10 and Junior Boy: \$10
- All Stewards to be present at their stands by 11.30am Sunday May 27 to enable exhibitors to collect their entries from 12 noon.

### THANK YOU TO OUR SHOW PAVILION SPONSORS FOR THEIR GENEROUS DONATIONS

**Bingara IGA & Hardware**

**MgGregor Gourlay (Bingara)**

**Goodas Wool Trading**

**Campbell's Fuel**

**Bingara Garden Club**

- Marlene Brown • Whitfeld Family • Kate Muir • Lindy Mill
- Laila Hosegood • Alf King • Gay Mack • The BBQ Men

**Thank you too, to all Section Stewards and their helpers for their time and effort.**

**We also thank the staff and students of Bingara Central School and Bingara Pre School and the Gwydir Shire Council.**



# Section 6 Farm Produce

Steward: Georgina O'Keeffe

## CONDITIONS OF ENTRY

- All grain exhibits to weigh approximately 2kg and be in a bag or box
- All dusted grain to be in a sealed container or bag

1. Wheat
2. Barley
3. Oats
4. Sorghum
5. Legume seed – 500 grams
6. Pasture seed – 500 grams
7. Any seed not mentioned
8. Hay – lucerne – 15cm
9. Hay – wheaten/oaten – 15cm
10. Honey - in jar
11. Honeycomb - in jar
12. Eggs - 6 bantam - one will be cracked
13. Eggs - 6 brown - one will be cracked
14. Eggs - 6 white - one will be cracked

**Champion Seed or Hay - Ribbon and \$50 Fuel Voucher.**

**Champion Honey - Ribbon and \$15 Open Order at Bingara IGA and Hardware.**

**Champion Eggs - Ribbon and \$15 Open Order at Bingara IGA and Hardware.**

# Section 7 Fruit & Vegetable Garden Produce

Steward: Gay Mack

## CONDITIONS OF ENTRY:

- All exhibits to be grown by the exhibitor.
- Exhibits to be presented on a small disposable plate.

1. Most unusual vegetable or fruit
2. Best Pumpkin - any variety
3. Pumpkin - Jap/Kent
4. Gramma
5. Silverbeet/spinach - bunch in jar
6. Leafy Greens - bunch in jar
7. Chokos - 3
8. Root vegetables
9. Chillies - any variety
10. Tomatoes - any variety
11. Bunch of Herbs - in jar
12. Vegetable not mentioned
13. Lemons - 3
14. Citrus - other
15. Fruit not mentioned
16. Assortment of fruit or Vegetables on a plate - Judged on variety and quality

**Best Pumpkin (classes 2 and 3) - Ribbon and \$20 donated by Gay Mack.**

**Champion Vegetable - Ribbon and \$20 Open Order at Bingara IGA and Hardware.**

**Champion Fruit - Ribbon and \$20 Open Order at Bingara IGA and Hardware.**

The logo for 'Sew Much More' features the words 'Sew Much More' in a large, elegant, cursive script. A small illustration of a needle and thread is positioned at the bottom left, with the thread appearing to pass through the letter 'o' in 'More'.

- FRESH FLOWERS
- CURTAIN MAKING
- QUILTING SERVICE
- FABRICS
- HABERDASHERY

**JACQUI BRENEGER**

**M; 0427 682 811**

**37 MAITLAND STREET, BINGARA**



# Section 8 Horticulture

## CONDITIONS OF ENTRY

- All entries to be grown by the exhibitor.
- Specimens to be displayed in a suitable clean and clear vase, bottle or container with the label removed.
- All Classes specifying "Specimen" must have one flower only- no other flowers or buds.
  - Definitions: NND - Not Necessarily Distinct: Distinct - Different.

## Section 8A – Cut Flowers

Steward: Shirley Witts

1. Specimen rose – one colour
2. Specimen rose – bi-colour
3. Full bloom rose – must show stamens
4. Three roses – one colour
5. Three roses – distinct colours
6. Six roses – distinct colours
7. Collection of roses – other than floribunda
8. Bud to full bloom – three stages, one variety (bud must show colour)
9. One cut floribunda
10. One rose bud – must show colour
11. Collection of David Austin roses - no more than 6
12. Climbing rose

### **Champion Rose (Classes 1-12) Ribbon and \$5.00 - Donated by Bingara Garden Club**

13. Specimen rose – miniature
14. Collection of miniature roses

### **Champion Miniature Rose (Classes 13 - 14) Ribbon and \$5.00 - Donated by Bingara Garden Club**

15. One cut exhibition chrysanthemum
16. One cut decorative chrysanthemum
17. One cut chrysanthemum - anemone centred
18. One cut chrysanthemum - single
19. One cut chrysanthemum - quill or spider
20. One cut button chrysanthemum
21. Three cuts chrysanthemum, distinct colour varieties
22. Collection of chrysanthemums (not more than one of each)
23. One gerbera
24. Three gerberas - any colour
25. Head of geranium
26. Three heads of geranium
27. Six heads of geranium
28. Head of ivy geranium
29. Specimen carnation
30. One cut flowering shrub or tree (non native)
31. One cut flowering shrub or tree (native)
32. Specimen truss or spike not previously mentioned
33. One cut most unusual flower
34. Collection of mixed flowers
35. One cut flower not mentioned

### **Champion Bloom other than Rose (Classes 15-35) Ribbon and \$5.00 - Donated by Bingara Garden Club**

### **Supreme Champion Exhibit (Classes 1-35) Ribbon and \$15.00 Open Order at Bingara IGA & Hardware**

AJ  
**HART BUILDING**  
SERVICES

- New Homes
- Extensions
- Renovations
- Commercial
- Insurance

**Andrew Hart**  
0424 372 702

Lic No. 149557C  
ABN 52 111 577 925

# Section 8 Horticulture (Continued)

## Section 8B – Potted Plants

Steward: Shirley Witts • Plants can be in an on-ground pot or hanging

1. Pot of flowering colour
2. Pot of foliage
3. Specimen fern
4. Potted grass - e.g. bamboo
5. Potted succulent
6. Potted herb garden
7. Potted item not mentioned

**Champion Potted Plant - Ribbon and \$5.00 - donated by Bingara Garden Club and \$15.00 Open Order at Bingara IGA & Hardware**

## Section 8C – Decorative

Steward: Shirley Witts

• Exhibitors may use purchased flowers. • A novice is a person who has not previously won first prize.

1. Formal arrangement
2. Novice formal arrangement
3. Arrangement of foliage
4. Artificial flowers
5. Arrangement of three flowers and foliage
6. From the paddock or roadside

**Champion Decorative Arrangement- Ribbon and \$5.00 - donated by Bingara Garden Club and \$15.00 Open Order at Bingara IGA and Hardware.**

## Section 8D – Junior Floral Art - 16 Years and Under

Steward: Shirley Witts

1. A vase of flowers
2. Decorated mask - using dried, fresh, natural or artificial material.
3. My favourite team using plant materials & embellishments.
4. Fruit or vegetable creature

**Champion Junior Floral Art (Classes 1-3) Ribbon and \$5.00 donated by Bingara Garden Club and \$5.00 Open Order at Bingara IGA & Hardware**

**Champion Fruit or Vegetable Creature (Class 4) Ribbon and \$5.00 donated by Bingara Garden Club and \$5.00 Open Order at Bingara IGA & Hardware**



# Section 9 Handicraft

## Section 9A – Handicraft

Steward: Kate Muir, Lynne Crawford

### CONDITIONS OF ENTRY

- Exhibits must be the sole work of the entrant
- Exhibits must have been completed during the last 12 months
- Every care is taken but no responsibility will be accepted for loss or damage to property
- Exhibits may be collected on Sunday from 12 noon.

1. Leatherwork – plaited article
2. Leatherwork – any article
3. Piece of woodturning
4. Piece of woodwork
5. Piece of woodwork furniture
6. Piece of canvas work – ready to hang
7. Collection of three craft articles – different medium
8. Collection of three craft articles – same medium
9. Article of folk art
10. Article of decorative art - milk can, tin etc.
11. Article using recycled materials
12. Ceramics - any article
13. Framed piece of needlework
14. Article by person over 70 years
15. Article by person over 85 years
16. Handmade jewellery and accessories
- jewellery, jewellery box, jewellery pouch, brooch pillow etc.
17. Sewing accessories - sewing bag or caddy etc.
18. Cloth doll - angels etc.
19. Gorgeous teddy
20. Christmas tree ornament and Christmas table accessories - table centrepiece, candle-stick holder, tea cosy, place mats, serviette ring, tablecloth
21. Scrapbooking - single page
22. Any article of welding
23. Paper craft- e.g. decorated card
24. Garden ornaments - e.g planter, windchimes
25. Garden furniture
26. Bags - e.g handbag, shoulder bag, toilet bag
27. Mosaic - any article
28. Article not previously mentioned

**Champion Handicraft (Classes 1-28) – Ribbon and \$25 Open Order at Bingara IGA & Hardware.**

## Section 9B – Junior Handicraft - 16 Years and Under

- All exhibits to be made by the exhibitor

1. Article of woodwork
2. Article of metalwork
3. Any article using recycled materials
4. Any article using natural products
5. Collection of three different craft articles
6. Handmade toy
7. Leggo/meccano/other construction – self designed Under 7 years
8. Leggo/meccano/other construction – self designed Under 10 years
9. Article not mentioned

**Champion Junior Handicraft (Classes 1-9) – Ribbon and \$10.00 Open Order at Bingara IGA & Hardware**





# Section 10 Cooking

Steward: Lindy Mill

## CONDITIONS OF ENTRY

- All entries are to be made by the exhibitor

• All cooking to be on a firm, foil-covered cardboard or other board and covered with clear plastic (e.g. cling wrap or oven bag)

## Section 10A – Open

1. Sponge cake - must be jam filled, not iced
2. Light fruit or sultana cake – 250g mixture
3. Dark fruit cake – 250g mixture
4. Chocolate cake - round or square tin, iced on top only
5. Citrus cake i.e lemon, orange or lime or any combination, iced on top only
6. Banana cake/loaf – may be iced, on top only
7. Decorated cake - novelty
8. Novelty decorated cup cake
9. Cake not listed - own choice
10. Six scones
11. Six pieces of slice – any variety
12. Six beautiful biscuits – any variety
13. Loaf of bread - any mix
14. Man's cake - cooked by gentlemen only

**Champion Piece of Cooking (Classes 1-14) – Ribbon and \$20 Open Order at Bingara IGA**  
**Champion Piece of Cooking by person over 70 years (Classes 1-14) - Ribbon and \$10 Open Order at Bingara IGA**

**CWA Encouragement Award - Recipe book donated by CWA Bingara Branch**

## Section 10B – Junior Cooking - 16 Years and Under

15. Six anzac biscuits
16. Six pikelets – one size
17. Six cup cakes – cooked in cup cases and iced
18. Quick mix cake – iced on top only (not packet mix)

**Champion Piece of Cooking (Classes 15-18) – Ribbon and \$10 Open Order at Bingara IGA & Hardware**

## 12 YEARS AND UNDER

19. Six Anzac biscuits
20. Six pikelets – one size
21. Six cup cakes – cooked in cup cases and iced
22. Quick mix cake – iced on top only (not packet mix)

**Champion Piece of Cooking (Classes 19-22) – Ribbon and \$10 Open Order at Bingara IGA & Hardware**  
**Junior Encouragement Award (Classes 15-22) – Recipe book donated by Lindy Mill**

## Section 10C – Decorated Biscuits

### PRESCHOOL AND SCHOOL (K-2) (NO ENTRY FEE)

23. Preschool and Family Daycare – best decorated biscuit – decorations must be edible
24. Kindergarten – best decorated biscuit – decorations must be edible
25. Year 1 – best decorated biscuit – decorations must be edible
26. Year 2 – best decorated gingerbread man – decorations must be edible

**Champion Decorated Biscuit (for each Class 23-26) – Ribbon and \$5 Open Order at Bingara IGA & Hardware**

**The Pavilion Stewards thank the staff at Bingara Central School and Bingara Preschool for their assistance.**

# Section 11 Jams, Preserves, Pickles

Steward: Helen Mitchell

## CONDITIONS OF ENTRY

- Jar or bottle tops to be covered with a piece of fabric.
- Jar or bottle to be labelled clearly with name of preserve, jam or pickle.

## Section 11A – Jams

1. Jar of fig jam
2. Jar of strawberry jam
3. Jar of melon jam – any flavour
4. Jar of tomato jam
5. Jar of apricot jam
6. Three jars of jam, three varieties
7. Jar of jam, any kind not mentioned
8. Orange marmalade

**Champion Jar of Jam (Classes 1-8) – Ribbon and \$15 Open Order at Bingara IGA & Hardware**

## Section 11B – Preserves and Pickles

9. Bottle of tomato relish
10. Bottle of fruit chutney
11. Bottle of chutney not mentioned
12. Bottle of tomato sauce
13. Bottle of choko pickles
14. Bottle of green tomato pickles
15. Bottle of clear pickles
16. Bottle of mustard pickles
17. Bottle of mixed pickled vegetables
18. Bottle of pickles not mentioned
19. Bottle of preserved fruit
20. Bottle of preserved vegetables

**Champion Preserve or Pickle (Classes 9-20) – Ribbon and \$15 Open Order at Bingara IGA & Hardware**



## BINGARA WATTLE ARTS & CRAFTS

HAND MADE GOODS AND GIFTWARE  
ART, JEWELLERY, LEATHERWORK, LEADLIGHT ART,  
KNITTED HANDWORK, QUILTS AND SEWING.  
EVERYTHING FOR THE PERFECT GIFT

**62 MAITLAND STREET  
BINGARA NSW**



# Section 12 Needlework & Cotton Crochet

Steward: Marlene Brown

## CONDITIONS OF ENTRY

- Washed or soiled work will not be judged

## Section 12A – Patchwork Quilt

1. Hand Pieced Quilt

2. Machine Pieced Quilt

**Champion Patchwork Quilt for each Class – Ribbon and \$25 Donated by Mrs. Marlene Brown.**

## Section 12B – Needlework

1. Table centre – embroidered
2. Duchess set – embroidered
3. One embroidered handkerchief
4. One guest towel – embroidered
5. Article of machine embroidery
6. Article of crewel
7. Article of candlewicking
8. Article of cross stitch
9. Prettiest coathanger
10. Cushion or cushion cover
11. Article of appliqué (hand stitched)
12. Article of appliqué (machine stitched)
13. Small article of patchwork
14. Machine made garment
15. Article not mentioned

**Champion Article of Hand Needlework (Classes 1-15) – Ribbon and \$20 Open Order at Bingara IGA & Hardware**

## Section 12C – Cotton Crochet

16. Duchess set white or cream – may have linen centre
17. Duchess set variegated or coloured – may have linen centre
18. Supper cloth – may have linen centre
19. One doily – variegated or coloured
20. One doily – white or cream
21. Centre – over 30 cm variegated or coloured
22. Centre - cream or white
23. One crochet edged handkerchief
24. Article of crochet – not mentioned
25. Article of crochet by person over 60 years
26. Article of crochet by person over 70 years

**Champion Article of Cotton Crochet (Classes 16-26) – Ribbon and \$20 Open Order at Bingara IGA & Hardware**

## Section 12D – Junior Needlework- 16 Years and Under

27. Article of Tapestry
28. Article of Cross Stitch
29. Article of Embroidery
30. Machine stitched article.

**Champion Junior Article of Hand Needlework and Cotton Crochet (Classes 27-30) Ribbon and \$10 donated by Mr Alf King in memory of Mrs Eileen King**

## Bingara Veterinary Clinic

Production and Health Care Services for large and small animals  
Sugical, Medical X-Ray and Ultrasound Services

Ph/Fax: (02) 6724 1000

35 Maitland Street, Bingara

Ben Gardiner  
Laura Martin

Kym Hagan  
Rebecca Roberts

Michelle Coulton





# Section 13 Knitting and Crochet

Steward: Jos Cooper

## CONDITIONS OF ENTRY

- Washed or soiled work will not be judged
- Wool, wool blend or wool substitute

## Section 13A – Knitting

- |                                        |                                               |                                     |
|----------------------------------------|-----------------------------------------------|-------------------------------------|
| 1. Infant's knitted garment            | 8. Knitted garment - patterned                | over 60 years                       |
| 2. Child's knitted garment - plain     | 9. Bulky knit garment                         | 15. Article by person over 60 years |
| 3. Child's knitted garment - patterned | 10. Item of Fair Isle knitting                | 16. Article not mentioned           |
| 4. Baby's matinee jacket               | 11. Accessory e.g. beanie, scarf, gloves etc. | 17. Knitted toy                     |
| 5. Baby's shawl                        | 12. Knitted article in cotton                 | 18. Knitted coathanger              |
| 6. Pair of booties                     | 13. Knitted rug                               | 19. Machine knitted article         |
| 7. Knitted garment - plain             | 14. Knitted rug by person                     |                                     |

**Champion Article of Hand Knitting (Classes 1-19) – Ribbon and \$20 Open Order at Bingara IGA & Hardware**

## Section 13B – Crochet

- |                                         |                     |                           |
|-----------------------------------------|---------------------|---------------------------|
| 20. Crochet rug                         | 22. Baby's garment  | 25. Crochet coathanger    |
| 21. Crochet rug by person over 60 years | 23. Baby's shawl    | 26. Crochet toy           |
|                                         | 24. Pair of booties | 27. Article not mentioned |

**Champion Article of Crochet (Classes 20-27) - Ribbon and \$20 Open Order at Bingara IGA & Hardware**

## Section 13C – Junior Knitting & Crochet- 16 Years and Under

- |                         |                        |
|-------------------------|------------------------|
| 28. Article of knitting | 29. Article of crochet |
|-------------------------|------------------------|

**Champion Junior Article of Hand Knitting or Crochet (Classes 28-29) – Ribbon and \$10 (Donated by Mr Alf King in memory of Mrs Eileen King)**



# Section 14 Photography

Steward: Jacqui Breneger

## CONDITIONS OF ENTRY

- Camera work must be the work of the exhibitor and **not** previously exhibited at the Bingara Show.
- **All prints and enlargements must be mounted on plain cardboard with a 2cm border all round.**
- Definition of Nature - Nature photography depicts untamed animals and uncultivated plants in natural habitat, trees, native animals, native birds, butterflies etc.
- All care will be taken with exhibits but no responsibility will be assumed for loss or damage to entries.
- Stewards reserve the right to reclass photographs that have been entered into the incorrect Section or Class.
- Section, class, name, address and phone number must be clearly shown on the back of the cardboard.
- Juniors to include date of birth on all entries.
- **All sections are open to 35mm or digital work.**
- Standard prints may be up to 5"x7" and enlargements up to 10"x15".

## Section 14A – Colour

- |                          |                       |                            |
|--------------------------|-----------------------|----------------------------|
| 1. Child/family study    | 5. Rural scene        | 9. Bingara community event |
| 2. Sunrise/sunset        | 6. Holiday snap shots | 10. Pet or pets            |
| 3. In my garden          | 7. Nature             | 11. Historical             |
| 4. Sports or action shot | 8. Reflections        | 12. Any other subject      |

**Champion Colour Photograph (Classes 1-12) – Ribbon and \$20 Open Order at Bingara IGA & Hardware**

## Section 14B – Monochrome (Black and White)

- |                        |                            |
|------------------------|----------------------------|
| 13. My family portrait | 15. Working on the land    |
| 14. Historical         | 16. Animal or nature study |

**Champion Monochrome Photograph (Classes 13-16) – Ribbon and \$20 Open Order at Bingara IGA & Hardware**

## Section 14C – Canvas Prints

17. Any subject, any size

**Champion Canvas Print (Class 17) – Ribbon and \$20 Open Order at Bingara IGA & Hardware**

## Section 14D – Junior - 16 Years and Under

18. Colour photograph  
19. Monochrome photograph

**Champion Junior Photograph (Classes 18 - 19) – Ribbon and \$10 Open Order at Bingara IGA & Hardware**

# Section 15 Art

Steward: Frances Young, Sue Hutton

## CONDITIONS OF ENTRY

- **Paintings, including school art, must be ready to hang.**
  - All care but no responsibility accepted for loss or damage.
- All entries must be the original work of the exhibitor and no copies are to be exhibited.
  - Artworks must not have been exhibited at any previous Bingara Show.
  - If unable to submit entry on the day, deliver exhibit to Ray White Rural, 23 Maitland Street, Ph: 6724 1170
- Exhibitors will be responsible for all freight charges to and from exhibition.
- If intending to sell artwork, state price (including 10% commission to the Bingara Show Society) together with your name, address and phone number.

## Section 15A – Art

1. Landscape – any medium
2. Still life – any medium
3. Animals – any medium
4. Portrait or figure – any medium
5. Contemporary – any subject – any medium
6. Any subject not mentioned - any medium

**Champion Artwork (Classes 1-6) – Ribbon and \$30 (Una Whitfield Memorial Prize) and \$25 Open Order at Bingara IGA & Hardware**

## Section 15B – Junior Art

- Name and school year to be put on back of painting

7. Preschool
8. Kindergarten
9. Years 1 & 2
10. Years 3 & 4
11. Years 5 & 6
12. Years 7 & 8
13. Years 9 & 10
14. Years 11 & 12

**Champion Junior Artwork (Classes 7-14) – Ribbon and \$15 Open Order at Bingara IGA & Hardware**  
The Pavilion Stewards thank the Staff of Bingara Central School and the Bingara Preschool for their contributions and assistance.

## Section 15C – Pottery

1. Junior
  2. Senior
- Champion for each class – Ribbon and \$15 Open Order at Bingara IGA & Hardware**

# Section 16 Collectors' Corner

Steward: Wendy Wearne

## CONDITIONS OF ENTRY:

- Exhibits to be in good condition
- Brief description of unusual items
- Provide display stands if possible
- Every care is taken but no responsibility will be accepted for loss or damage to property

1. War memorabilia
2. Old school memorabilia
3. Wedding paraphernalia
4. Antique jewellery
5. Powder compact
6. Gentleman's neck apparel
7. Hat
8. Theatre memorabilia
9. Old sporting equipment
10. Item not mentioned

**Champion Collectors' Corner – Ribbon and \$20 Open Order at Bingara IGA & Hardware**



# Section 17 Home Brew Competition

## 2018 BINGARA SHOW

### BEST HOME BREW COMPETITION

The Brew Shed Inverell proudly sponsors the 2018 Bingara Show home brew beer competition.

The competition is open to all levels of home brewers.

If you already have some home brew on hand but feel that it's not up to competition standard, don't despair. Brewers of all levels are encouraged to participate, as this is a useful way of learning how to improve your future brews with the informative and confidential 'feedback' score sheet for you to keep.

**The winners of each beer style will receive:**

- Overall Best Home Brewed Beer Champion – A4 coloured certificate, plus a \$30 gift voucher thanks to **The Brew Shed** and a Bingara Show ribbon.
- First place – A4 coloured certificate, plus a \$20 gift voucher thanks to **The Brew Shed**.
- Second place – A4 coloured certificate, plus a \$15 gift voucher thanks to **The Brew Shed**.
- Third place – A4 coloured certificate, plus a \$10 gift voucher thanks to **The Brew Shed**.

#### BEER STYLES / CATEGORIES - ENTRY FORM

Please use a separate form for each bottle entered;

tick appropriate box

Light beer

Dark Beer

Cider

1. Payment in full of \$1 per bottle at time of drop off. Please ring Robyn Phillips on 0409 770 994 to arrange drop off /collection.

2. Entries close at 9am on Friday morning **25th May, 2018**.

3. Entries submitted can be at room temperature or cold.

4. All care will be taken but no responsibility accepted.

5. Please mark the bottle clearly with your name and category and contact number.

6. Upon entry the contents becomes the property of the Bingara Show Best Home Brew Competition, and after judging, the contents of the bottle will be discharged to waste.

7.(empty) bottles and prizes will be ready for collection on site at the end of the show.

8. Entries will be judged on presentation as well as content.

**BEER STYLES/CATEGORIES**

Light Beer - Dark Beer - Cider

ENTRANTS NAME : .....

Address .....

TOWN .....

MOBILE: .....